



Installation Guide

Ribbon Remover- Yamaha FZR, FXSHO

Part# WR04001

Parts Included: 1x WORX ribbon remov-

Installation Instructions

1. Disconnect lanyard. Remove seats.
2. Remove plastic engine cover.
3. At right side of engine, locate rubber hose between the intercooler and throttle body. See Pic A.)
4. Remove bolt securing connecting pipe to engine. (Pic A.) Loosen hose clamps and remove pipe (Pic A.)
5. At the front of the intake manifold, remove bolt securing oil dip stick tube to manifold (Pic B.)
6. At underside of intake manifold remove the two bolts securing manifold to manifold support bracket. (Pic B.)
7. At top of intake manifold remove the two cap nuts securing manifold to cylinder. (Pic B.) Loosen the remaining six bolts securing intake manifold to cylinder (Pic B.)
8. Remove the four nuts and washers securing throttle body to throttle body joint. (Pic C.) Pull intake manifold away from motor and remove throttle body.
9. Remove the four m8 bolts securing throttle body joint to intake manifold. (Pic C.) Remove throttle body unit. Note: Be careful not to lose or damage o-ring (Pic C.)
10. Remove ribbon with holder from intake manifold inlet. (Pic C.) Remove outer rubber holder and discard ribbon.
11. Place holder around outside of supplied WORX sleeve. (Pic D.) Note: Direction of rubber holder in relation to marking on supplied billet sleeve is critical.
12. Install WORX sleeve with rubber holder into intake manifold inlet. (Pic D.) Note: Direction of rubber supplied WORX sleeve is critical. White spot to side that faces throttle body.
13. Replace throttle body unit making sure o-ring is in place between unit and intake manifold. Secure with stock hardware. Note: Apply blue loc-tite to bolts. Torque to 9.6 ft lbs.
14. Replace throttle body making sure gasket is in place between throttle body and throttle body joint. Secure with stock hardware. Note: Apply blue loc-tite to bolts. Torque to 9.6 ft lbs.
15. Replace cap nuts and secure intake manifold to cylinder. Note: Torque in sequence to 14.8 ft lbs. Refer to Pic B. For torque sequence
16. Replace the two bolts securing intake manifold to manifold support bracket and the one bolt securing oil dip stick tube to manifold. Note: Apply blue loc-tite to bolts. Do not over tighten bolts.
17. Replace pipe connecting intercooler to throttle body. Note: Do not over tighten clamps.
18. Replace plastic engine cover. Installation is now complete!

See next page for pics...

Se

S

Pic A.

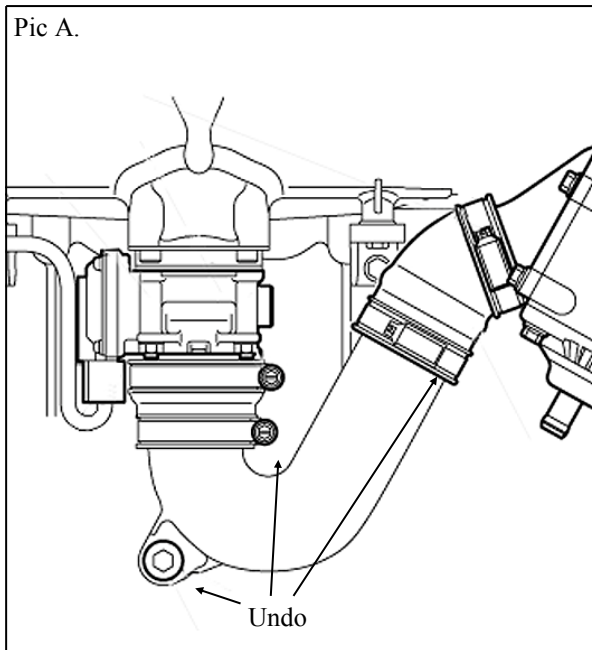

Pic B.

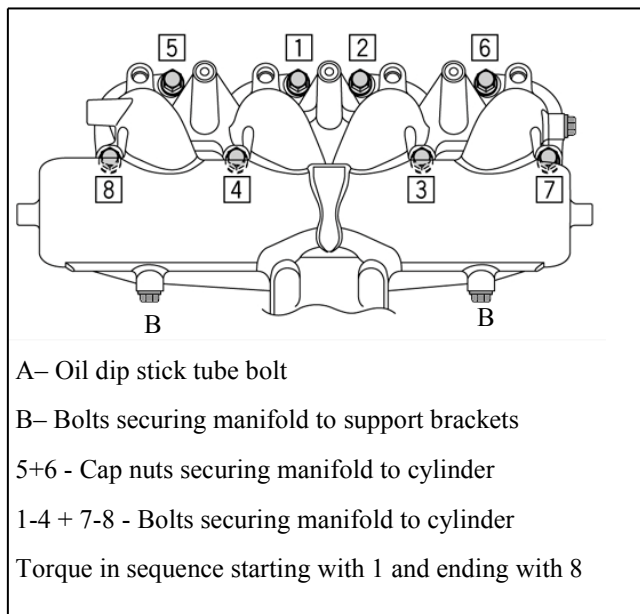

Pic C.

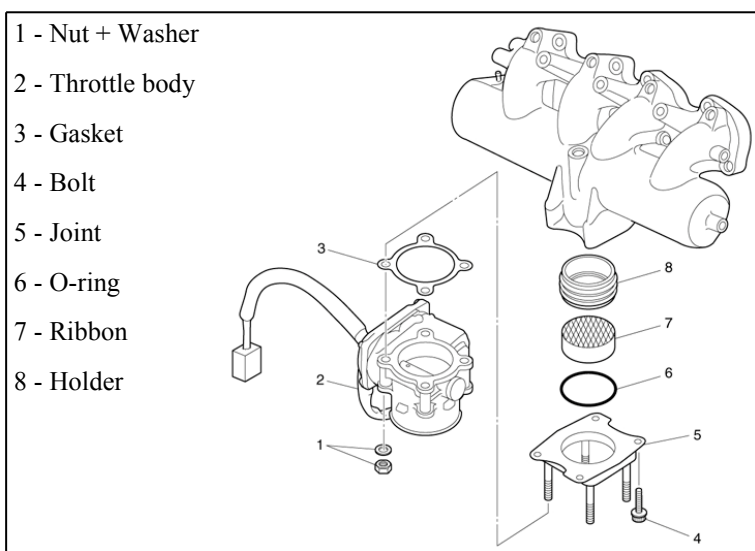

Pic D.



WORX
 RACING COMPONENTS

**Technical
 Support**

For answers to inquiries regarding installation or trouble shooting WORX products contact us by email

info@worx.com.au